

CREATIVECHEF®

◆ From Spain ◆

TINY SMOKE MACHINE SG16



www.cacc-china.com

E-mail : shenzhen@cacc-china.com

Tel: +86 755-22309198



**※ IMPORTANT SAFEGUARDS**

READ ALL INSTRUCTIONS CAREFULLY BEFORE USE

- Do not touch hot surfaces. Use handles or knobs.
- To protect against TINY SMOKE MACHINE entire unit in water or other liquid.
- Do not allow the children to use the Tiny smoke machine .
- Do not put the Tiny smoke machine near a hot gas or in a heated oven.
- Do not leave the Smoking box unattended when using the TINY SOMKE MACHINE.
- The metal cover of the TINY SMOKE MACHINE becomes very hot when in use. Please make sure the device to cool completely before touching cover, cleaning, or storing.
- Always use the TINY SMOKE MACHINE in an upright position.
- Two to three minutes under smoke is generally all that is needed to infuse foods with a smoky flavor and aroma.



※ IMPORTANT SAFEGUARDS

- Use a match or lighter to ignite the wooden chips in the TINY SMOKE MACHINE.
- DO NOT USE a kitchen torch or other heat device ignite the wooden chips as the excessive heat may damage the unit.
- Never operate the TINY SMOKE MACHINE without the stainless steel mesh filter in place.

OPERATION

1. Put the 2XAA battery into the TINY SMOKE MACHINE

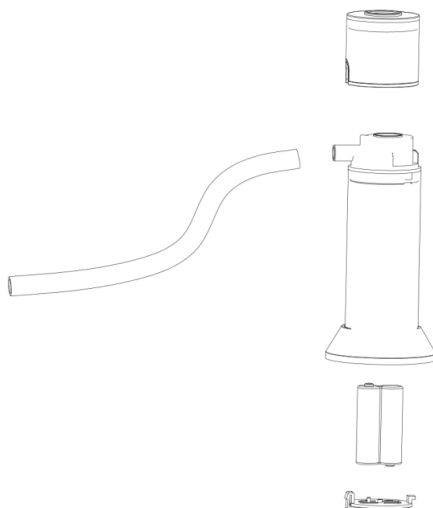



OPERATION

2. Put the chips in the hole then fire the wooden chips and press the power button.

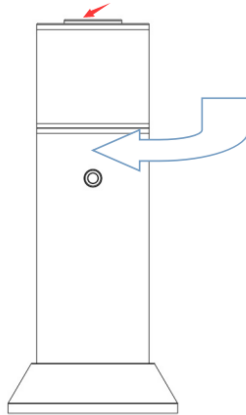

3. After finishing the cook , please wait until the metal cover is cool, then remove the head and clean it.





※ 重要安全指示

在使用前请仔细阅读说明

- 不要接触发热表面，请使用把手或捏手。
- 为了保护微型烟熏机，禁止将整个机器浸入水或其他液体中。
- 禁止儿童使用烟熏机。
- 禁止将烟熏机靠近热气体或放置在加热的烤箱中。
- 必须在有人看管的情况下使用烟熏机。
- 在使用时金属盖会发热，请确保在其冷却后接触，清洗和储藏。
- 请在直立状态下使用烟熏机。
- 2-3分钟烟雾通常是用来给实物注入烟熏味和香味。
- 用火柴或打火机点燃烟熏机中的木屑。
- 不能使用厨房中的燃气灶和其他加热装置点燃木屑，因为过热会损坏机器。
- 不能在没有不锈钢过滤网的情况下操作烟熏机。



操作示意图

1、请加两节5号电池后使用。

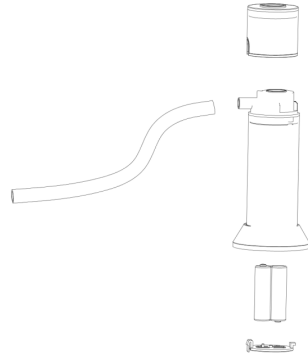

2、请把木屑放在燃料仓里面，
然后按下电源开关
最后点燃木屑。

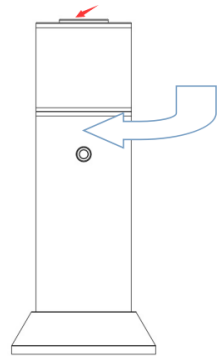

3、使用完毕后，请等到金属盖冷却后，
再从机身上拆卸下来，然后进行清洗。





维修与售后

1. 保修仅限生产缺陷及家庭使用之前造成的损坏。
2. 因使用不当或其他非产品本身质量问题造成的损坏，将收取零件成本及维修费。
3. 请保留相关购买凭证。

维修卡

顾客姓名：

联系电话：

联系邮箱：

联系地址：

产品型号：

购买日期：

经销商：

维修记录	维修日期	维修原因	维修员

CREATIVECHEF®

◆ From Spain ◆

Thank you again for purchasing the TINY SOMKE MACHINE SG16 from our company. Please enjoy your use. If you have any questions during use, please feel free to contact us.

再次感谢您购买我司的烟熏机SG16，祝您使用愉快。在使用的过程中如有任何疑问请及时与我司联系！

Opinhui (Shenzhen) International Trading Limited Company

Address: Room 301, Floor 3, No. 23, Baili Road, Bantian Avenue, Longgang District, Shenzhen

Phone: +86 755-22309198

Web: www.cacc-china.com

欧品汇 (深圳) 国际贸易有限公司

深圳市龙岗区坂田街道百利路23号3楼

电话: +86 755-22309198

网址: www.cacc-china.com.